

Skid unit with a piston pump

Horizontal stainless steel tank
High pressure

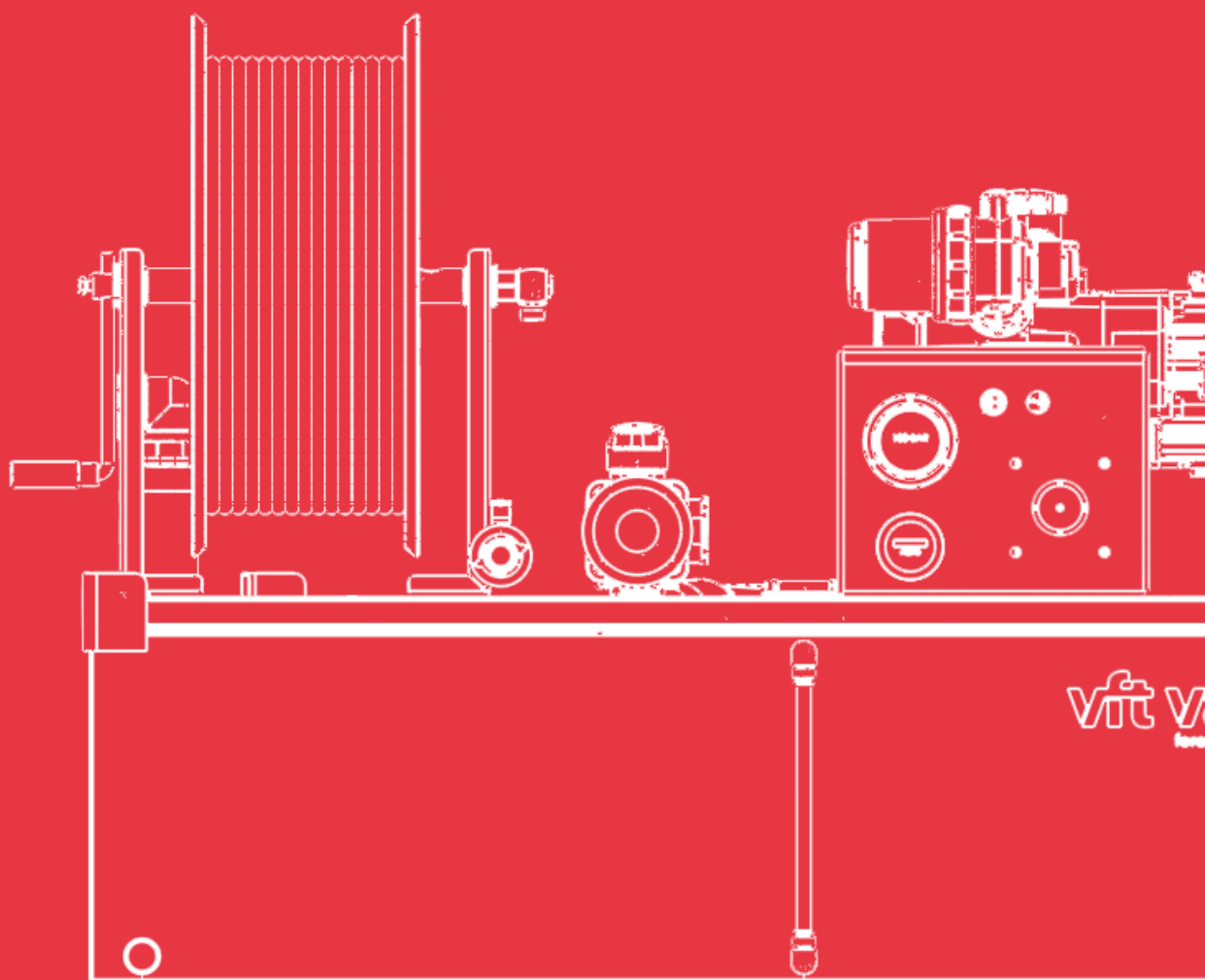

Horizontal skid unit with a piston pump

High pressure | Up to 200 bar

Rapid intervention skid units designed for pickup vehicles and trailers, equipped with piston pumps up to 200 bar with a maximum flow of up to 42 L/min.

- High-quality components and great replacement part availability
- Resistant tanks made of 2 mm AISI-304 stainless steel
- The best quality/price ratio
- 2 year warranty



What is included?

Motor

Gasoline (13.5 HP)

Piston pump

From 21 l/min | 200 bar to 42 l/min | 100 bar

Quick attack winder

Equipped with a high-pressure hose

Water tank

450 L or 600 L

Attack nozzle

Multi-purpose water and foam

Suction oversleeve

5 m long

Foam-forming agent proportioner system

2.5mm injector

Uses

Wildland fires

Less recommended

Container and vehicle fires

Recommended use

Cleaning and unclogging

Recommended use

1 Motor pump unit

Available options. 4-stroke gasoline combustion motors and 3-piston high-pressure volumetric pumps.



Motor	Power *	Pump	Max. pressure **	Max. flow **
B&S XR2100	13.5 HP	XWL 42.10 N	100 bar	42 l/min
B&S XR2100	13.5 HP	XW 21.20 N	200 bar	21 l/min

☐ Gasoline motor.

* The nominal engine power indicated in this document is the net power tested on a production engine for the engine model pursuant to SAE J1940 (Briggs & Stratton) at a specific speed. This value may vary in mass produced motors. The actual output power of the engine installed on the end machine will vary depending on a number of factors such as the applicable engine operating speed, the environmental conditions, maintenance and other variables.

** These values are at direct pump outlet.

*** The power, pressure and flow values are valid in working conditions: temperature 25°C at sea level. **IMPORTANT:** Engine power will decrease 3.5% for every 300 meters above sea level and 1% for each 5.6°C above 25°C.



2 Water tank

Vallfirest horizontal stainless steel tanks have an optimized design that provides a low center of gravity under the skid unit for greater vehicle stability. The shape can be adjusted to the dimensions of the loading area to optimize the available space.

- Made of 2 mm AISI-304 stainless steel.
- 2 longitudinal and 1 transversal breakwaters to prevent water from moving to the side to ensure vehicle stability.
- 1 1-1/2" filling spout on the top with couplings (Barcelona, Storz, Guillemin or others) to fill the tank from a hydrant or pressurized external water source.
- 1 configurable 1-1/2" high vent on the top.
- 1 hinged inspection cover with a useful diameter of 320 mm to inspect the tank.
- A water level indicator over connecting ducts.
- A 3/4" drain to empty the tank.
- Pump return connection to fill the tank by suctioning water from a non-pressurized external water source.
- The tank connects to the vehicle with 4 fixing points.
- Features 4 hoisting points to load and unload the skid unit safely.
- Enameled.

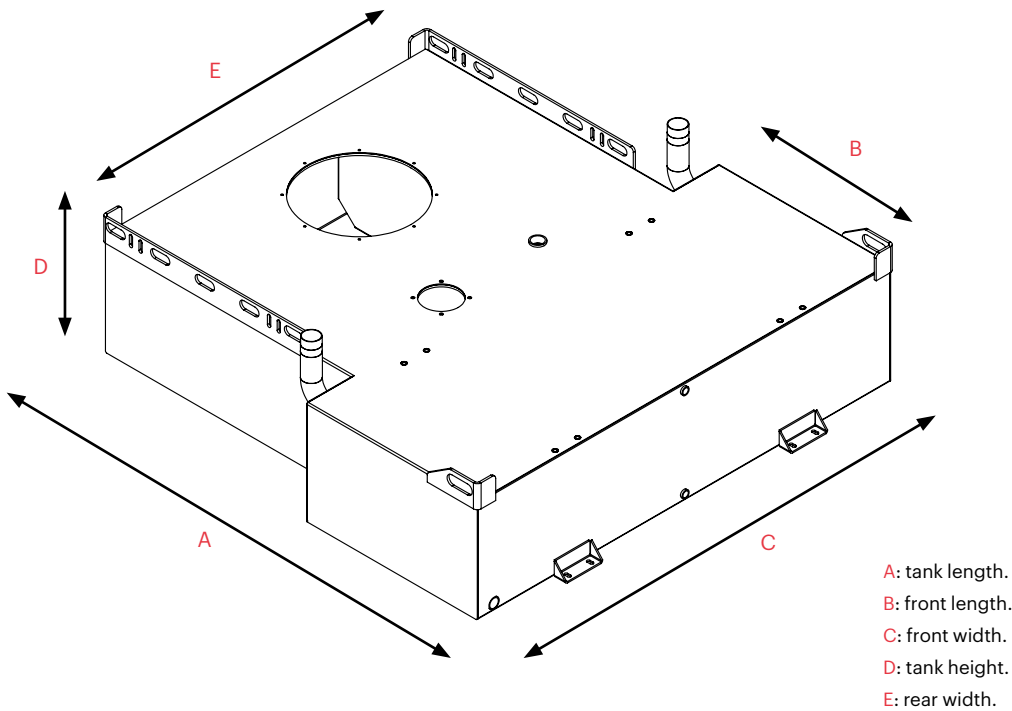

Standard colors		Tank dimensions				
Yellow White Red Stainless Steel Customizable color upon customer request.		Tank	A [mm]	B [mm]	C [mm]	D [mm]
		450 HD	1380	570	1300	370
		600 HD	1380	570	1300	480
						1010

3 Components included

3.1 Control panel

Control panel with LED light switch, pressure gauge, time counter, pressure regulator, filter, valves for suction and water drive, and foam percentage regulation knob.

TECHNICAL DATA

- Baked paint coating



3.2 Winder

Made of anti-corrosive material with a manual starting crank and lock system.

TECHNICAL DATA

- Capacity for 50 m long DN12 hose*



3.3 Foam-forming agent proportioner system

Compact and easy-to-use, foam mixing with a proportional manual selector valve. Creates a stable mix of foam-forming agent in the water. Venturi effect "in line eductor" system which mixes water and foam-forming agent in the drive circuit.



3.4 Suction oversleeve

Clear flexible PVC spiral absorption oversleeve with rigid PVC spiral and smooth inner surface. Includes non-return foot valve and filter. Includes a Storz connector for connection to the Vallfirest skid unit.

TECHNICAL DATA

- Length: 5 m
- Oversleeve diameter: DN25 (1")
- Weight: 2.2 kg (DN25)



3.5 Hose

DN12 (1/2") or DN10 (3/8") rigid hose as per the pump model. Comprised of an inner layer of synthetic rubber reinforced with 1 metal mesh (R1AT) or 2 meshes (R2AT). Features a quick connection system for a multi-purpose water and foam nozzle.

TECHNICAL DATA

Hose type as per the operating pressure:



- SAE 100 R1AT DN12 (1/2"): 160 bar operating pressure, 0.45 kg/m weight
- SAE 100 R2AT DN12 (1/2"): 275 bar operating pressure, 0.65 kg/m weight
- Ask for other hose lengths



3.6 Multi-purpose nozzle

High-pressure and high-range nozzle for water and foam. With quick connection system.*

TECHNICAL DATA

- Maximum pressure: 250 bar
- Maximum flow: 45 L/min.
- Concentrated stream > 
- Hollow cone/fog stream > 
- Foam stream > 

* Ask about options for 280 bar skid units



3.7 Tank lifting structure

Tank frame enabling the tank to be lifted and transported by means of a pallet jack or forklift.

DATOS TÉCNICOS

- 100*50*2 mm steel tube, 1400 mm long section.
- Durable powdercoated finish.

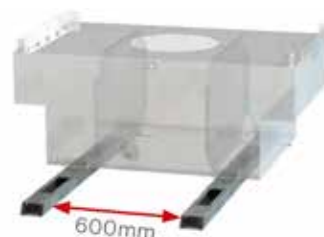

4 Optional accessories

4.1 Nozzles

Water

High-pressure and high-range nozzle. Adjustable angle. Interchangeable ceramic nozzle tip and quick connection system.

TECHNICAL DATA

- Maximum pressure: 220 bar
- Maximum flow: 45 L/min.
- Concentrated stream > —
- Hollow cone/fog stream > ◀



Foam

High-pressure and high-range nozzle. Adjustable angle. With quick connection system.*

TECHNICAL DATA

- Maximum pressure: 280 bar
- Maximum flow: 45 L/min.
- Concentrated stream > —
- Hollow cone/fog stream > ◀



4.2 100 m Manual winder

Made of anti-corrosive material with a manual starting crank and lock system.

TECHNICAL DATA

- Capacity for 100 m flat 25 hose

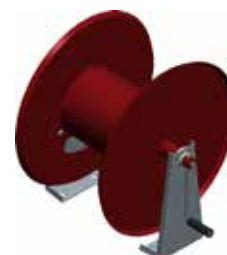

4.3 Electric winder

Made of anti-corrosive material. With an electric rewinder with a 12V motor.

TECHNICAL DATA

- Capacity for 50 DN12 (1/2") hose
- Ask for longer hose lengths..



4.4 Tool carrier structure

Different possibilities; fully customizable. The operability of pickup vehicles is increased with tool carrier structures accompanying the skid units: manual tools, drip torches, chainsaws, water packs, combat packs.

TECHNICAL DATA

- Features a tool carrier cabinet
- Features an equipment carrier tray with a railing
- Approximate total weight: 30 kg



5 General Dimensions

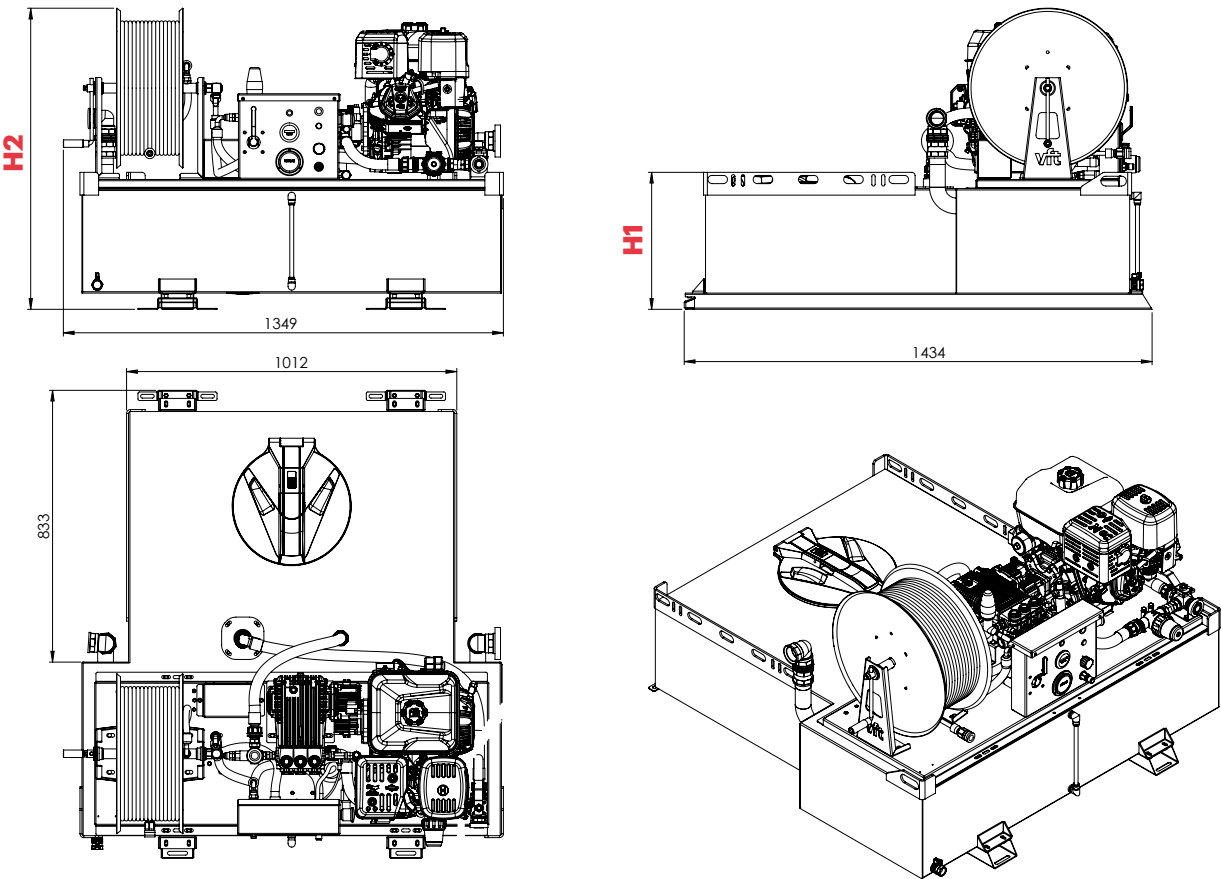

6 Configurations available

Ref. VFT	Tank	Motor	Battery and electric start	Power *	Pump	Max. Pressure **	Max. flow **	Approx dry weight	H1 [mm]	H2 [mm]
DVD1445-G63A0	450 HD	B&S XR2100	YES	13.5 HP	XWL 42.10 N	100 bar	42 l/min		420	925
DVD1445-G67A0	450 HD	B&S XR2100	YES	13.5 HP	XW 21.20 N	200 bar	21 l/min		420	925
DVD1460-G63A0	600 HD	B&S XR2100	YES	13.5 HP	XWL 42.10 N	100 bar	42 l/min		530	1035
DVD1460-G67A0	600 HD	B&S XR2100	YES	13.5 HP	XW 21.20 N	200 bar	21 l/min		530	1035

HD: horizontal tank, double cabin.

☐ Gasoline motor.

* The nominal engine power indicated in this document is the net power tested on a production engine for the engine model pursuant to SAE J1940 (Briggs& Stratton) at a specific speed. This value may vary in mass produced motors. The actual output power of the engine installed on the end machine will vary depending on a number of factors such as the applicable engine operating speed, the environmental conditions, maintenance and other variables.

** These values are at direct pump outlet.

*** The power, pressure and flow values are valid in working conditions: temperature 25°C at sea level. **IMPORTANT:** Engine power will decrease 3.5% for every 300 meters above sea level and 1% for each 5.6°C above 25°C.

Any questions? Contact us: clientes@vallfirest.com | T. +34 938 678 779